

SHORTENED FULL-HEIGHT TURNSTILE CYCLONE

The shortened version of Full Height Turnstiles - this is an unusual but effective way to protect your territory. Due to its design, the turnstile gives an impression of light but solid terminal perfectly fitting public areas that require reliable, but at the same time elegantly controlled access to the premises.



 20
pers./min
CROSSING CAPACITY

 550
mm
PASSAGE WIDTH

*IS A GREAT CHOICE FOR A BUDGET AND TASTE TO BE EMBODIED
IN ONE ITEM FOR ITS STRONG MECHANISM AND NICE BODY*

Controlled by:

- access control system;
- manual control

When power goes OFF both directions are closed

To be delivered additionally:

- manual unlocking in case of unavailable power;
- readers for access control system;
- remote radio controller;
- backup battery 12 V, 7 A•h;

Electrical Specifications:

- Voltage:
 - from the AC (100-240)V, 50/60Hz;
 - from s DC source 12 V
- Maximum power consumption 350 Watt per pass;
- Degree of protection according to GOST 14254-96 - IP41

Technical Specifications:

| | |
|------------------|---------|
| Length | 1560 mm |
| Width | 1438 mm |
| Height | 1300 mm |
| Weight, not more | 250 kg |



www.tiso.global
+380 (44) 291-21-11
e-mail: export@tiso.ua



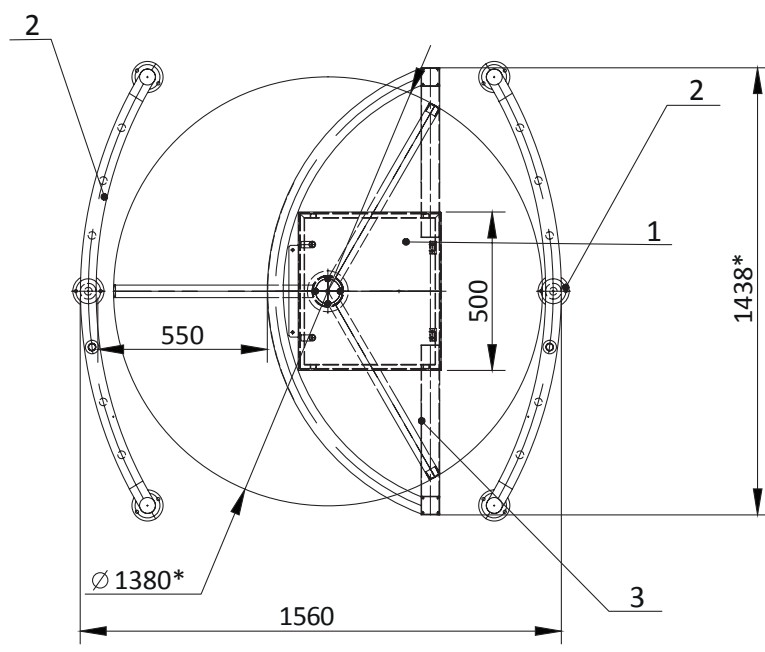
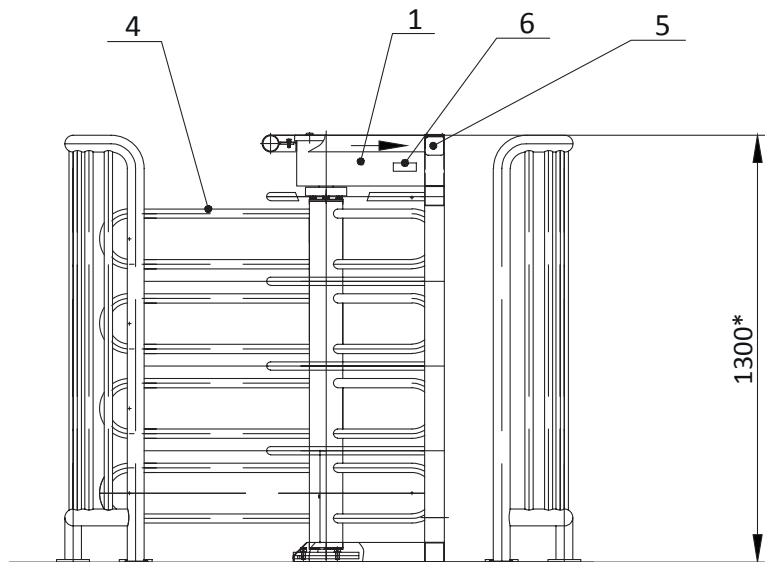

- 1 - container;
- 2 - enclosure wall;
- 3 - frame;
- 4 - rotor with U-shaped rods;
- 5 - LED display;
- 6 - counter of passers



www.tiso.global
 +380 (44) 291-21-11
 e-mail: export@tiso.ua

